



parsteel® 

MEZZANINE RACKS



Parsteel distributes the highest quality, full-line assortment of material handling and storage equipment in the industry. Our products combine years of proven engineering with the latest technology and supply chain practices. With manufacturing plants strategically located throughout the world, we can provide the right solution for every storage application. By maintaining a strong economic focus along with our commitment to the most stringent quality standards, Parsteel is your complete global storage solution.

## MEZZANINE RACKS



Optimize space by doubling or tripling warehouse surface area quickly and easily. Mezzanine structures can be disassembled, modified and reused to complement any facility while allowing valuable ground space to remain open for other storage. Mezzanines will allow you to utilize the maximum height of a warehouse and double or triple the surface area. Adding a Mezzanine can be the most economical way to increase warehouse space without the cost of a conventional building expansion. When designing a Mezzanine, it is important to consider the access-ways, work systems, products, and handling methods in order to plan accurately. Mezzanines may be completely disassembled; the parts re-used; and the structure, dimensions, and location easily modified.

### ADVANTAGES

- Customization at a competitive price.
- Prompt, reliable project management.
- Smaller investment compared to building add-on.
- Streamline operations.
- Standard beam-to-column connections designed for higher seismic zones.
- Connection designs are assembly-friendly for fast installation, with minimal disruption.

- Maximize existing space.
- Professional look and attention to detail.

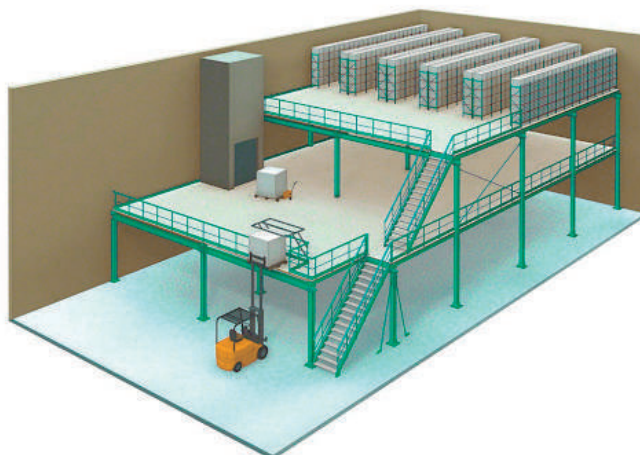

# COMPONENTS

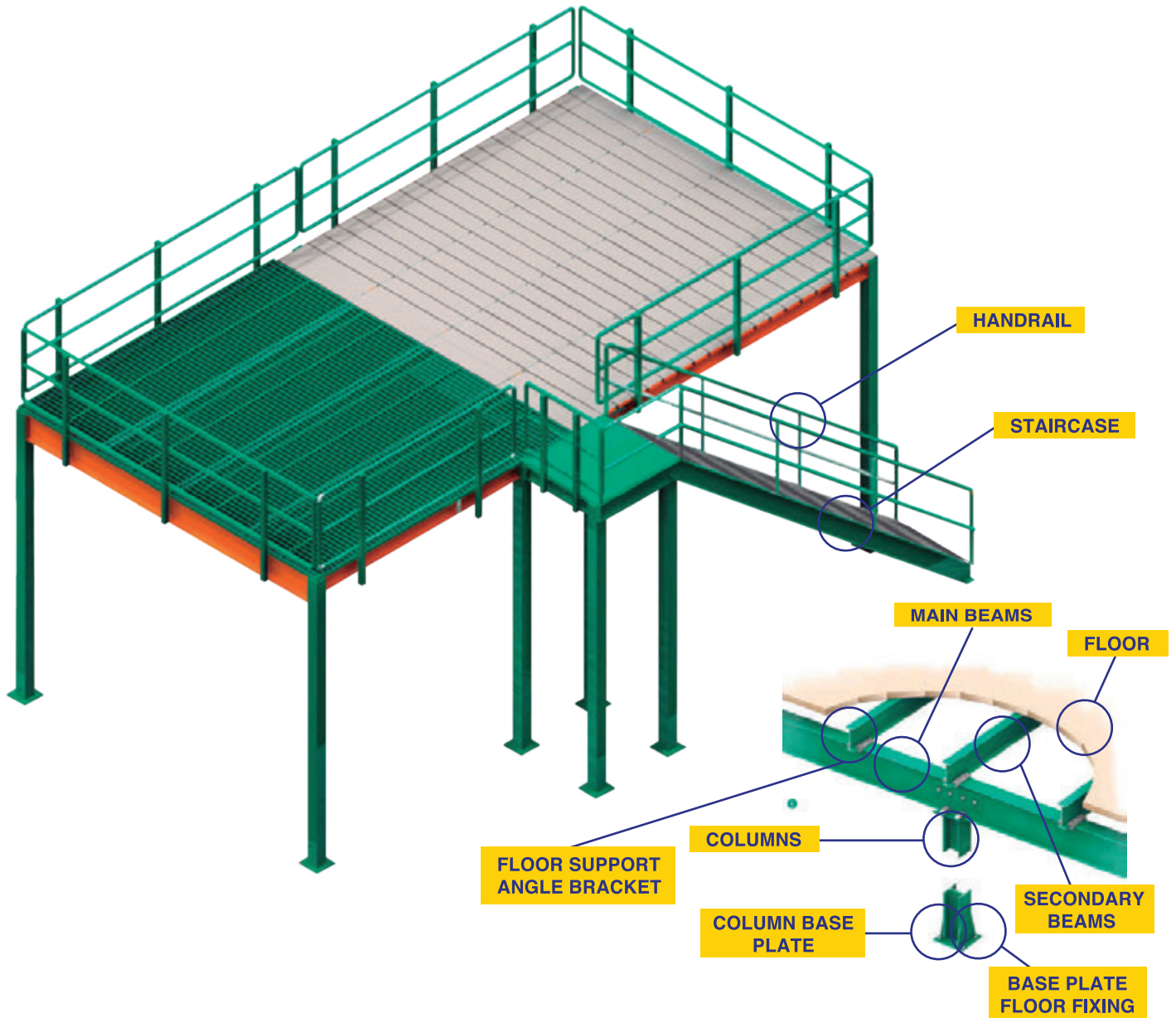

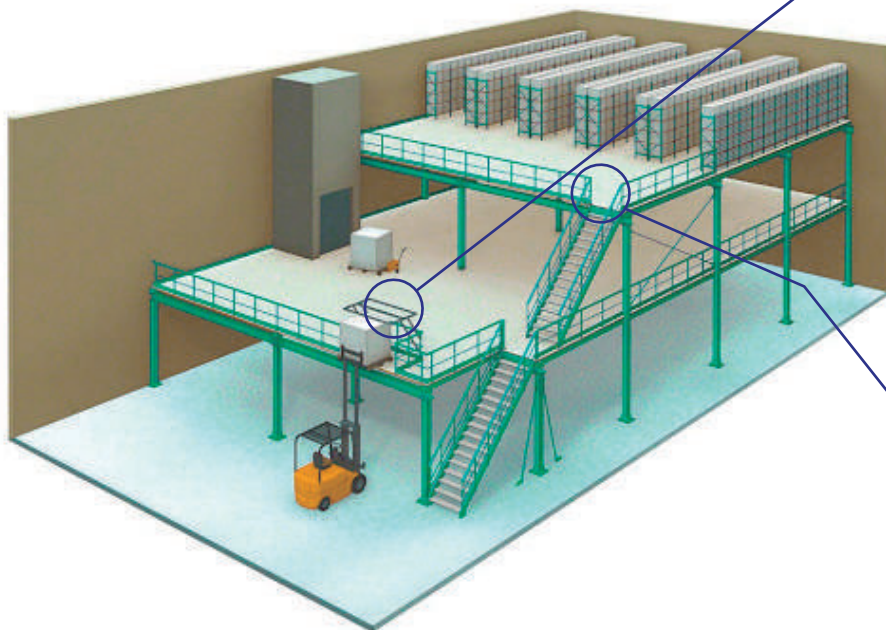

**UP AND OVER  
PALLET GATE**

This is the best system for creating a product loading and unloading bay when lift trucks and pallet forks are used. The weight of the assembly is balanced to make it easier to open and close the space.



**SAFETY ZONE**

This is marked by the railings, creating a space exclusively for depositing goods, whenever a loading and unloading zone is required.

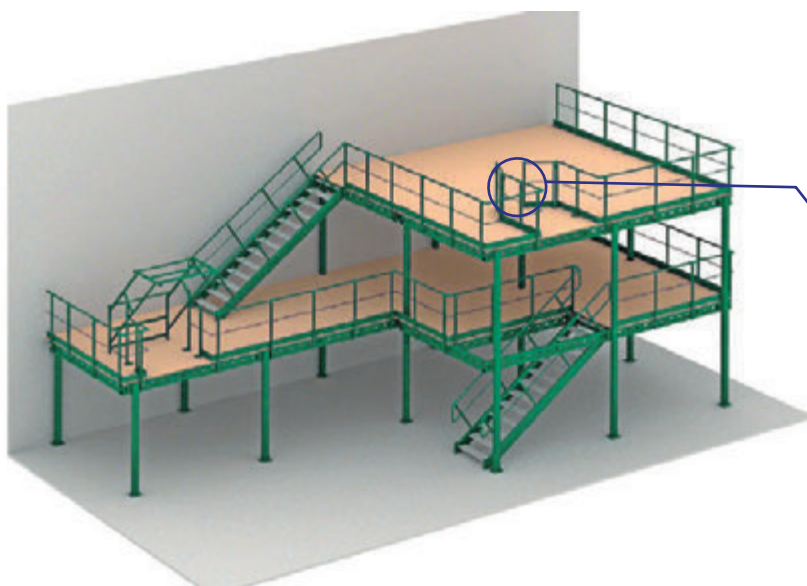

**SWING GATE**

This opens inwardly, with a stop at the bottom and a security latch at the top. It permits access to goods from outside or limits the work area.

# APPLICATIONS

The installation of mezzanines enables the utilization of different applications in that area, from work areas, to component assembly, preparation orders, storage, etc. even office placement. The installation consists of two raised floors. The ground floor has been fitted with shelves for storing small and medium sized goods and a larger amount of picking operations. The top floor is used to store large or less frequently consumed products.

- The mezzanine is connected to a picking storage area by walkways that serve as reception and order reparation area, it has a platform lift attached to it to lift and lower products from different levels.
- Mezzanine with offices for the control and management area installed in a factory.
- Storage of products of various formats.
- Mezzanines with rail systems for hanging garments.
- Combination of conveyor circuits and storage area.
- Isolated work areas.
- Workshop Warehouse.



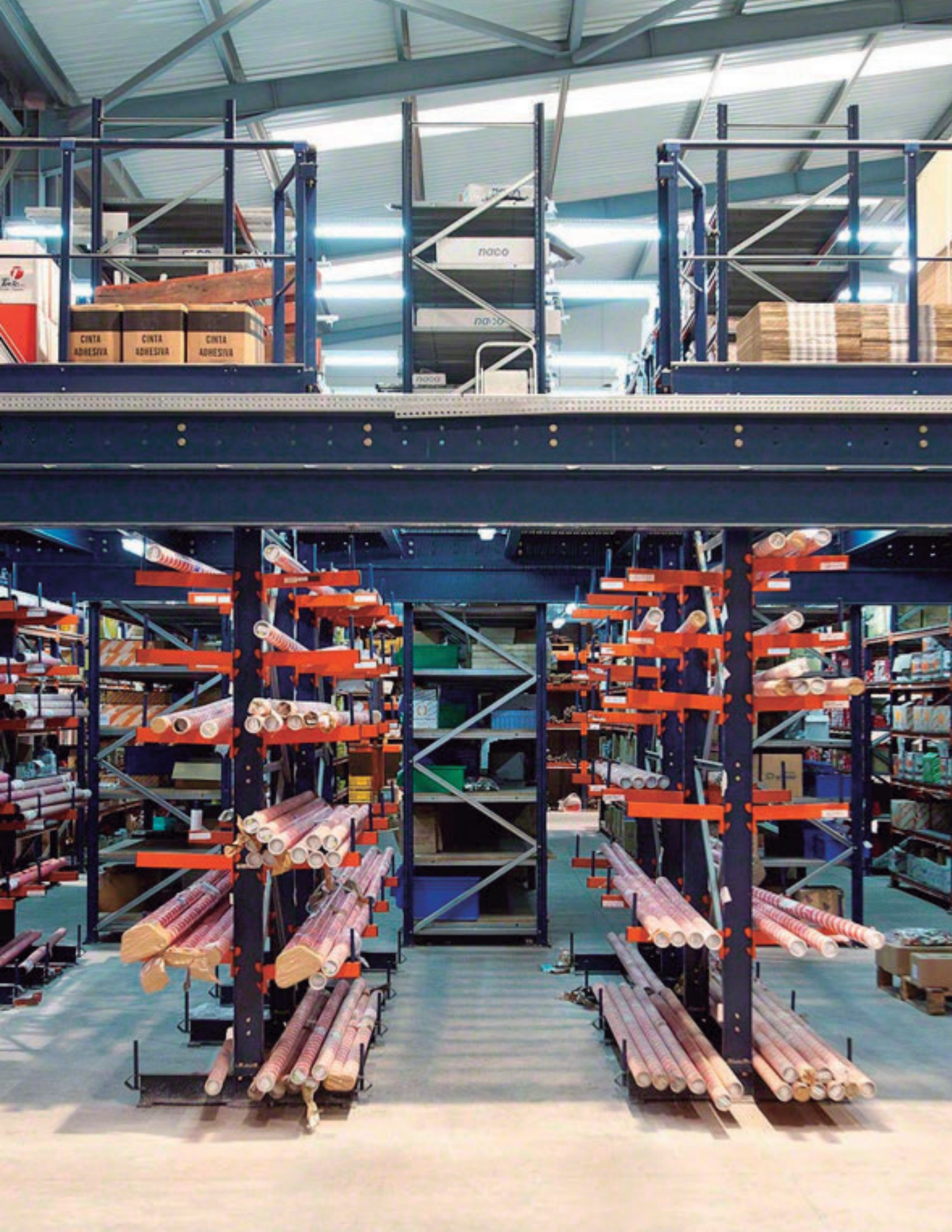

CINTA ADHESIVA CINTA ADHESIVA CINTA ADHESIVA

PACO

PACO

PACO



**SELECTIVE PALLET RACK**



**DRIVE-IN RACKING**



**PUSH BACK RACKING**



**GRAVITY FLOW RACKING**



**MOBILE RACKING**



**RIVET SHELVING**



**CANTILEVER RACKING**



**MATERIAL HANDLING**



**LOCKERS**

Also available from

**parsteel**® 

7525 West 20th Ave  
Hialeah, FL 33014 USA  
[www.Parsteel.com](http://www.Parsteel.com)



tel. 305-821-3000  
tel. 1-800-881-1885